

STATUTORY DECLARATION

SECTION 31 (6) OF THE HIGHWAYS ACT 1980

I GRAHAM FREDERICK CHARLES MELLSTROM DO SOLEMNLY AND SINCERELY
DECLARE as follows:

1. I am a director of Bays Leap Dairy Farm Limited (Company Registration No. 3813823) of Barry House 20/22 Worple Road London SW19 4DH been since 13th day of October 2000 the owner of the land known as land at East Farm Black Callerton Newcastle upon Tyne more particularly delineated on the plan accompanying this declaration and thereon edged red.
2. On the 4th day of December 2002 I deposited with Newcastle City Council, being the appropriate Council, a statement accompanied by a plan delineating my property by red edging which stated that the way coloured purple on the said plan and the accompanying this declaration had been dedicated as a footpath and that no other ways have been dedicated as highways over my property.
3. No additional ways have been dedicated over the land edged red on the plan accompanying this declaration since the statement dated 27 November 2002 referred to in 2. above and at the present time Bays Leap Dairy Farm Limited has no intention of dedicating any public rights of way over it's property.

AND I MAKE this solemn declaration on the 9th day of December 2002 conscientiously believing it to be true and by virtue of the Statutory Declarations Act 1835.

Declared at *International House*
Before me *Awaycott Lamb*

[Signature]
Commissioner for Oaths/Justice of the Peace/Solicitor

RURAL PROPERTY SERVICES LTD.

40 Priestpottle, Hexham, Northumberland NE46 1PQ

Tel: 01434 608980

© Rural Property Services Ltd

East Farm Rights of Way
Parish: Woolswington

SCALE
1:5000



Reproduced from the O.S. map with the permission of the
Controller: HMSO Crown Copyright reserved.
OS Licence E5773182

Farm Boundary
Footpath Alignment

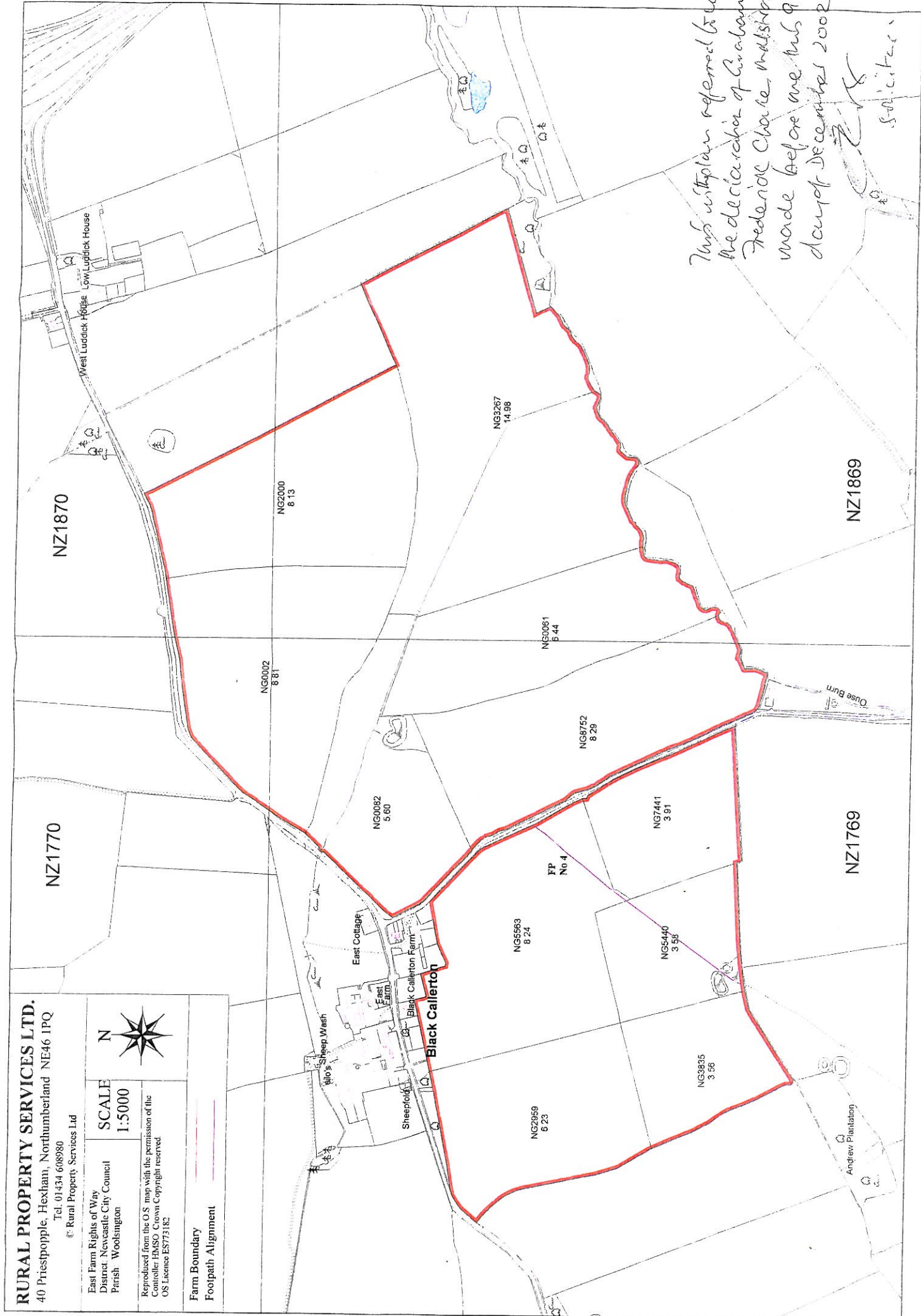

*This outplan referred to in
the declaration of Curator
Frederic Chaire, Matshon
made before me this 9th
day of December 2002*

Z. J. S. Solicitor

DEPOSIT OF STATEMENT AND PLAN

SECTION 31 (6) OF THE HIGHWAYS ACT 1980

To Newcastle City Council

1. I am a director of Bays Leap Dairy Farm Limited which has been since 13th day of October 2000 the owner within the meaning of the above section of the land known as land at East Farm Black Callerton Newcastle upon Tyne more particularly delineated on the plan accompanying this statement and thereon edged red ("the Property")
2. The aforementioned land lies in the Parishes/Communities of Black Callerton and Woolsington.
3. The way coloured purple on the said plan has been dedicated as a footpath
4. There are no other ways over the Property which have been dedicated as highways
5. The deposit shall comprise this statement and accompanying plan.

Dated 27/11/02 2002

Signed

G F C Mellstrom
G F C Mellstrom, Director of Bays Leap Dairy Farm Limited

Bays Leap Dairy Farm Limited (Company Registration no. 3813823) of Barry House 20/22
Worple Road London SW19 4DH

Signed (witness)

J.G. Waite

Name (of witness)

J.G. WAITE

Address

NEARACRE, HEADLEY ROAD, GRAYSHOTT,
HINDHEAD, SURREY GU26 6LL

Occupation

Secretary

RURAL PROPERTY SERVICES LTD.
40 Priestpoppole, Hexham, Northumberland NE46 1PQ

Tel. 01434 608980
© Rural Property Services Ltd

East Farm Rights of Way
District: Newcastle City Council
Parish: Woolington

SCALE
1:5000



Reproduced from the OS map with the permission of the
Controller HMSO Crown Copyright reserved
OS Licence E5773182

Farm Boundary
Footpath Alignment

